



# Socket Type Insulator Fittings

## Socket - Eye, Standard

### Material

Ductile iron hot dip galvanized

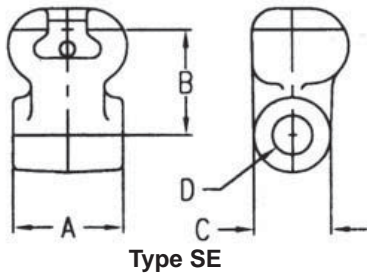

Type SE

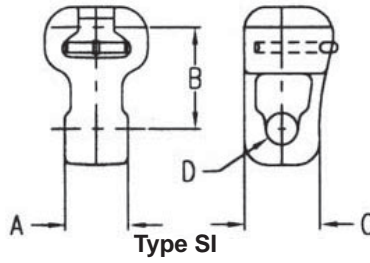

Type SI

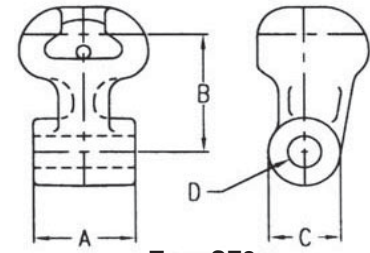

Type SE8

Catalog Number	For Insulator Class	A	B	C	D	Ultimate Strength (lbs)	Weight /100 (lbs)
SI-500	*ANSI 52-3 & 5	1/2	2 3/16	1 5/8	11/16	18000	108
SI-625	*ANSI 52-3 & 5	5/8	2 3/16	1 5/8	11/16	20000	111
SI-750	*ANSI 52-3 & 5	3/4	2 3/16	1 5/8	11/16	25000	113
SE-750-6	*ANSI 52-3 & 5	3/4	2 3/4	2	13/16	30000	180
SI-875	*ANSI 52-3 & 5	7/8	2 3/16	1 5/8	11/16	30000	115
SE-875-6	*ANSI 52-3 & 5	7/8	2 3/16	1 11/16	13/16	30000	121
SE-1000-6	*ANSI 52-3 & 5	1	2 3/8	1 11/16	13/16	30000	185
SI-1062	*ANSI 52-3 & 5	1 1/16	2 5/16	1 5/8	11/16	30000	117
SI-1125	*ANSI 52-3 & 5	1 1/8	2 3/16	1 5/8	11/16	30000	118
SE-1250-6	*ANSI 52-3 & 5	1 1/4	2 3/8	1 11/16	13/16	30000	235
SE-1250-8	*ANSI 52-3 & 5	1 1/4	2 1/2	2	1 1/16	30000	235
SI1375	*ANSI 52-3 & 5	1 3/8	2 3/16	1 1/2	11/16	30000	122
SI-1375-6	*ANSI 52-3 & 5	1 3/8	2 3/16	1 5/8	13/16	30000	128
SE-11	*ANSI 52-3 & 5	1 3/8	2 3/8	1 5/8	11/16	30000	22
SE-1625-6	*ANSI 52-3 & 5	1 5/8	3	1 3/4	13/16	30000	195
SI-1750	*ANSI 52-3 & 5	1 3/4	2 3/16	1 1/2	11/16	30000	130
SE-1750-6	*ANSI 52-3 & 5	1 3/4	2 11/16	1 5/8	13/16	30000	240
SI-2000	*ANSI 52-3 & 5	2	2 3/16	1 1/2	11/16	30000	138
SE-2000-6	*ANSI 52-3 & 5	2	2 3/16	1 9/16	13/16	30000	230
SI-2187	*ANSI 52-3 & 5	2 3/16	2 3/16	1 1/2	11/16	30000	146
SI-2500	*ANSI 52-3 & 5	2 1/2	2 3/16	1 1/2	11/16	30000	168
SE-2500A-6	*ANSI 52-3 & 5	2 1/2	3	1 3/4	13/16	30000	255
SE8-1437-6	ANSI 52-8 & 11	1 7/16	5 5/16	2 1/4	13/16	45000	580
SE8-1437-7	ANSI 52-8 & 11	1 7/16	5 5/16	2 1/4	15/16	50000	580
SE8-1437-8	ANSI 52-8 & 11	1 7/16	5 5/16	2 1/4	1 1/16	50000	580
SE8-1437-9	ANSI 52-8 & 11	1 7/16	5 5/16	2 1/4	1 3/16	50000	580
SE8-1625-6	ANSI 52-8 & 11	1 5/8	3 3/8	1 3/4	13/16	45000	335
SE8-1750-6	ANSI 52-8 & 11	1 3/4	3 3/8	1 3/4	13/16	45000	340
SE8-2187-6	ANSI 52-8 & 11	2 3/16	3 3/8	1 3/4	13/16	45000	378
SE8-2500-6	ANSI 52-8 & 11	2 1/2	3 3/8	1 3/4	13/16	45000	382
SE8-3250-7	ANSI 52-8 & 11	3 1/4	3 3/8	2	15/16	50000	420

**Notes:**

1) ANSI 52-5 & IEC 16mm are generally accepted as being interchangeable